

**CAUTION: READ ALL INSTRUCTIONS PRIOR TO ASSEMBLY.
INSTALLATIONS BY QUALIFIED ELECTRICIANS ONLY**

IMPORTANT - DECLARATIONS & WARNINGS

All Barn Light Australia lighting products are designed to be assembled, installed, and finished by a fully-licensed Electrician.

For outdoor ratings to be valid, junctions between the mounting surface and the luminaire must be sealed using supplied gaskets, with an outdoor-rated, UV Resistant silicon used on the mounting surfaces.

Broke something? Might have lost parts? - Call Barn Light. We've got spares. If you believe any facet, part, or component is damaged - Call Barn Light. We're here to make your job easier, both now and in the future.

WIRING DIAGRAM

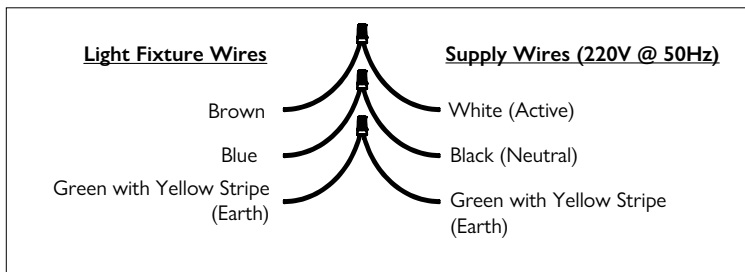

INSTRUCTIONS - MOUNTING & WARNINGS

1. Disconnect power from the electrical panel before installation.
2. Remove the **Electrical Assembly (A)** from package and remove **Terminal Block (G)**.
3. Turn the **Hex Coupler (E)** and seated **Coupler O-Ring (D)** by turning Counter-Clock Wise (Left Hand Thread) to release, remove from the Electrical Assembly (**A**).
4. Place the **Electrical Assembly (A)** within the **Shade (C)** and pull the wires through, ensuring the Hex pattern matches up with the **Electrical Assembly (A)**. Ensure the supplied **Hex-Gasket (B)** is flat onto the **Electrical Assemblies (A)** base.
5. Thread Electrical Cables through the **Hex Coupler (E)** and turn clock-wise to tighten down onto the shade (**C**).
6. Apply Silicon Tape or Plumbers Compound onto the **Mounting Arm's (F)** Threads if not already done.
7. Push the **Electrical Assembly (A)** through the **Mounting Arm (F)**, then rotate the **Shade (C)** Clockwise until no threads are visible. Provide a good 1/4 turn to ensure the threads lock (and become water-tight).
8. Place the completed assembly onto your **Post Mount Arm (H)** continue to follow the "Post Mount Base" instructions shown in the bottom right.
9. Finally using the supplied Terminal Block (**G**) connect the lighting fixture to supply wires. Affix completed Post Mount Assembly to your Post using the supplied 6x M10 Grub Screws (**I**) and M10 Bolt (**J**) as desired.

Ensure The Outside Diameter Direct Burial Poles / Sign Light Posts / Poles of either material is at most:

Aluminium	- 78mm (2-1/2")
Steel	- 76mm (65NB // Nominal Bore)

POST MOUNT FIXTURES

- A. Electrical Assembly (Not Shown)
- B. Hex Gasket
- C. Shade
- D. Coupler O-Ring
- E. Hex Coupler
- F. Post Mount Arm
- G. Terminal Block
- H. Post Mount Arm (Not Supplied)
- I. Grub Screws (x6)
- J. Hex Bolt (x1)

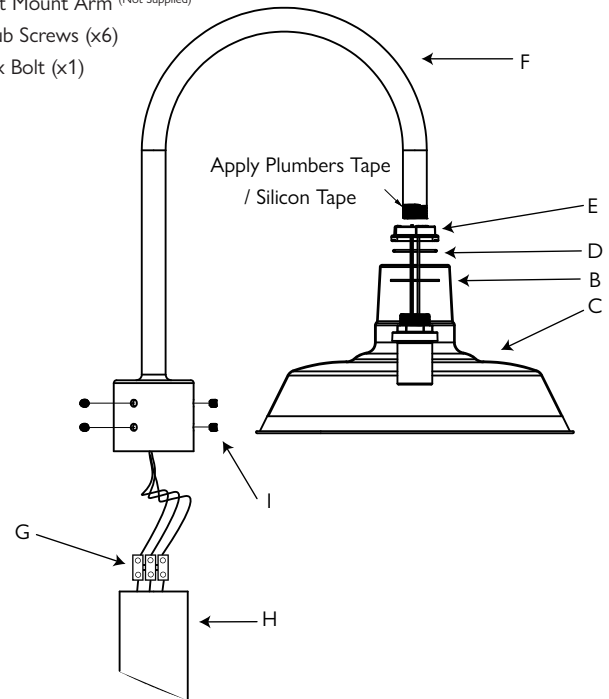

POST MOUNT BASE

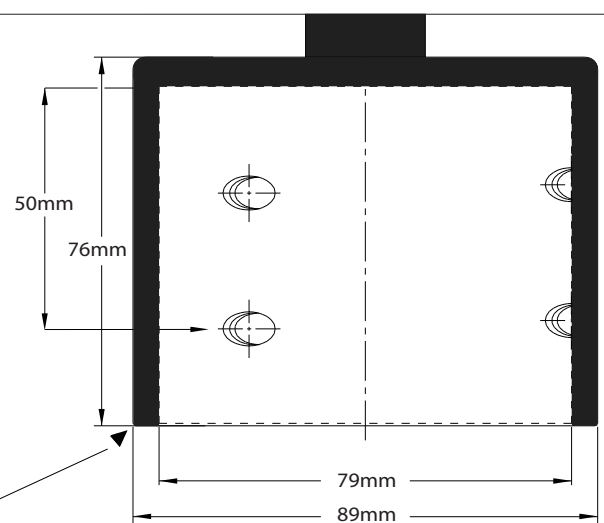

1. Mark 50mm from the Top of Post and drill a 11mmØ Hole at centre.
2. Use supplied **Hex Bolt (J)** 1x M10x1.5mm Bolt to affix to Post Mount Base. Remove 1x Grub Screw if required.
3. This additional bolt will prohibit the post mount from turning on own axis during windy events further will reduce "rattling" in high winds.